

PERFORMANCE:

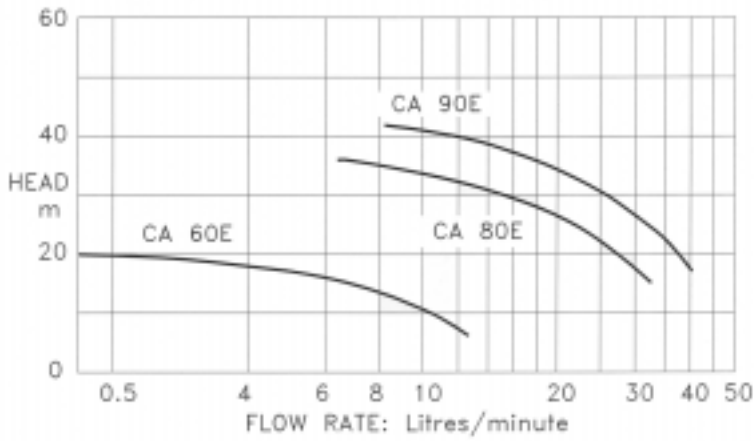

Pump Model	3-phase motor	
	kW	full load current A
CA 60E	0.15	0.6
CA 80E	0.45	1.3
CA 90E	0.55	1.7

Pump Model	1-phase motor	
	kW	full load current A
CAM 60E	0.15	1.2
CAM 80E	0.45	3.6
CAM 90E	0.55	4.5

MOTOR:

3-phase 400v ±10% - 50Hz
 1-phase 230v ±10% - 50Hz with thermal overload cut-out
 Insulation class F, Speed 2900rpm
 IP54 enclosure, aluminium frame

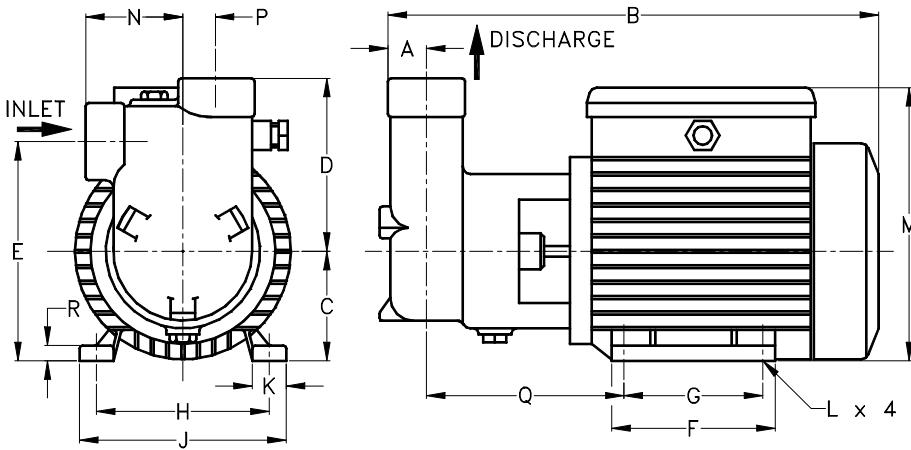

PORTS BSP INTERNAL THREADED

Dimensions in mm

Model	A	B	C	D	E	F	G	H	J	K	L	M	N	P	Q	IN	OUT
CA60E	18	256	63	65	103	96	80	100	122	22	7	158	45	14	103	1/2"	1/2"
CA80E	23	272	63	90	126	106	90	100	122	22	7	158	55	17	109	3/4"	3/4"
CA90E	28	318	71	112	142	106	90	112	134	22	7	180	63	21	128	1"	1"

MATERIALS OF CONSTRUCTION:

Pump body	Cast iron
Impeller	Brass
Shaft	Stainless steel
Mechanical shaft seal	Carbon-ceramic

CA-series

SELF-PRIMING LIQUID RING PUMP



- ◆ Diesel fuel transfer
- ◆ Self-priming up to 5m
- ◆ Will handle entrained air
- ◆ Continuous duty for ambient temperatures up to 40°C